

DISCOVERY HALL

MAP KEY



Stairs, Restroom and Elevator



Destinations



Meeting & Group Study

FLOOR
1

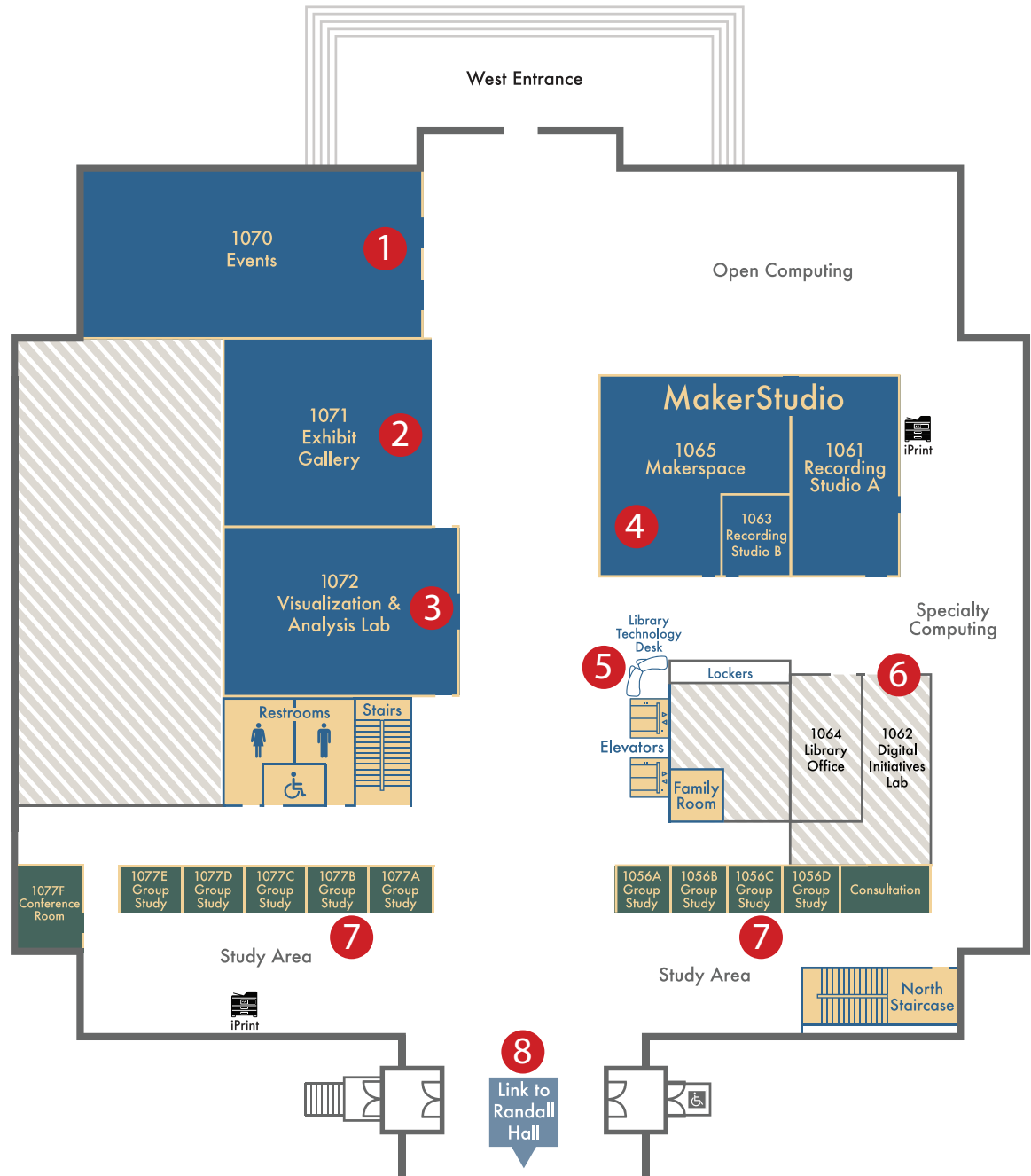

UNCW Library, Discovery Hall Self-Guided Tour

**Tours start at the Discovery Hall entrance on the first floor (faces College Rd.)*

First Floor

1. Event Space

- Available for high-profile UNCW sponsored events and functions, especially those that have university-wide appeal and are open to the community

2. Library Research Gallery

- Dynamic **exhibit space** for digital and traditional exhibitions curated by the library and through partnerships

3. Visualization and Analysis Lab

- Immersive 30-foot-long video touch-enabled display wall available for classes, events, presentations, and collaboration related to working with and visualizing data and/or graphics-rich content

4. The MakerStudio

- The Makerstudio features several distinct spaces:
 - Expanded **makerspace** with 3D printing, laser cutting, embroidery, and other fabrication (DH1065)
 - Multipurpose **podcasting and media studio** (DH 1063)
 - **Production studio** for creating audio and video content (DH1061)
 - Featuring soundproofing, green screen wall, and studio lighting

5. Library Technology Desk

- Personal assistance with library hardware, software, printers, and more from tech-savvy employees
- Support for many of the technology-enhanced spaces located on the first floor of the Discovery Hall

6. Digitization Lab

- Where the Library's Digital Initiatives unit does **high-quality digitization** of a variety of materials, such as scrapbooks capturing local history, local government documents, and regional newspapers, using high-capacity specialized scanner

7. Group Study Coves

- Includes 9 spaces with collaboration technology that are available on a first-come, first-served basis

8. Link

- Connects Randall Hall and Discovery Hall and contains hot/cold vending machines and Market 47, which provides prepacked sandwiches, salads, and more - we also have the patio to the north and the lawn to the south with wifi to take the library outdoors

DISCOVERY HALL

MAP KEY ● Stairs, Restroom and Elevator ● Destinations ● Meeting & Group Study

FLOOR
2

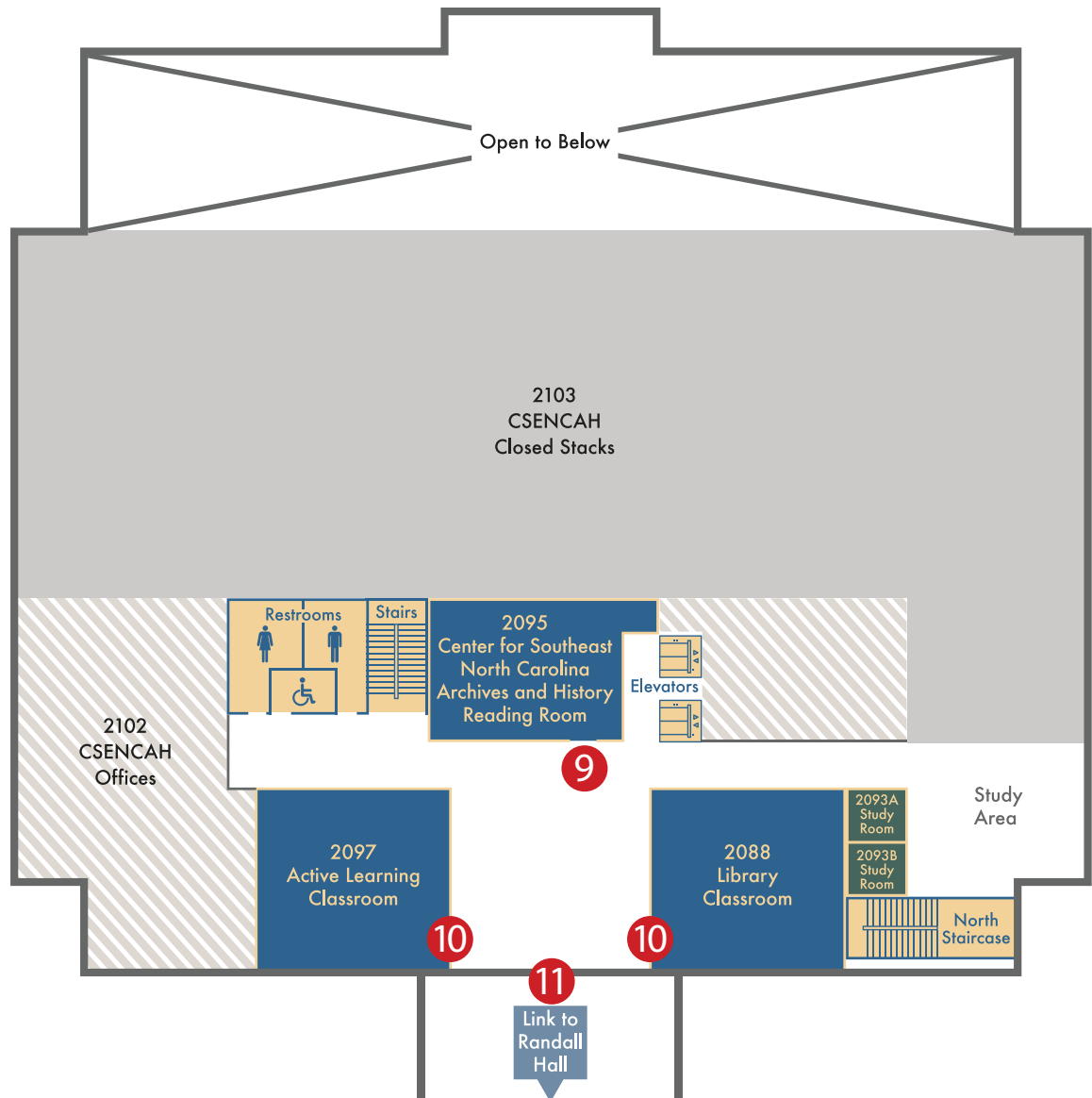

**Take elevator to Second Floor*

Second Floor

9. CSENCAH

- The Center contains original archival collections, rare and locally significant publications, and other historical documentary materials related to the Southeast NC region, including the library's Special Collections, government documents, and UNCW's University Archives
- While the Center's collections are open for use, because these materials are so unique and historically valuable, they are kept in secure closed stacks that are accessible only to staff. Anyone who wants to access the Center's collections can visit the reading room during their open hours
- The Center is used by hundreds of researchers across the country each year and open to the public and the UNCW community

10. Classrooms

- Used for course integrated library instruction and library workshops
- Active classroom (DH 2097) has moveable furniture and connective technology that allows for students to actively collaborate with the instructor and with each other

11. Link

- Second floor connection to Randall Hall features extensive seating with ample natural light

DISCOVERY HALL

MAP KEY ● Stairs, Restroom and Elevator ● Destinations ● Meeting & Group Study

FLOOR
3

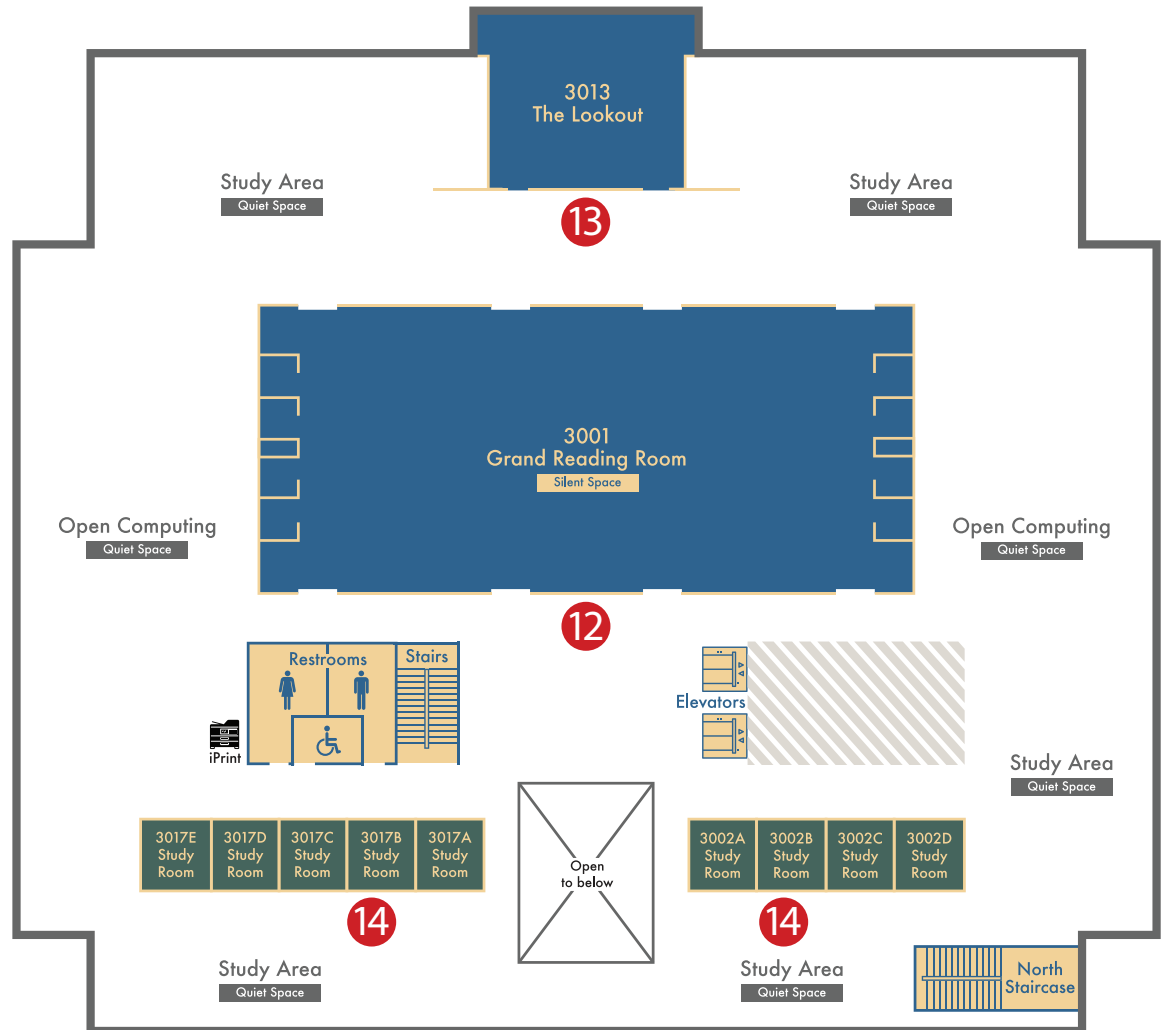

**Take elevator to Third Floor*

Third Floor: This floor boasts 100 percent student space and plays host to an original Dorothy Gillespie sculpture found hanging on the wall directly parallel to the elevators.

12. Grand Reading Room

- Deep quiet, silent study space with 12 semi-private study carrels that feature adjustable lighting

13. Lookout

- Facing sprawling pine trees, students truly experience learning on display in this space for respite, relaxation, and contemplation
- Framing the top of the room, you can find a custom mural designed and painted by alumnus Carleigh Sion

14. Group Study Rooms

- This floor features 9 enclosed rooms equipped with collaboration technology (2 more on the second floor of Discovery Hall and 30 more in Randall Hall)